



VISION • EXPERIENCE • RESULTS

www.etminc.com

tel 904-642-8990 • fax 904-646-9485

14775 Old St. Augustine Road • Jacksonville, Florida 32258

August 20, 2021

Mr. John Pappas
Director of Public Works
City of Jacksonville
214 N. Hogan Street, 10th Floor
Jacksonville, Florida 32202

Re: Widening of Race Track Road

Dear Mr. Pappas,

We are pleased to submit to you the enclosed documents related to the proposed widening of Race Track Road from Bartram Park Boulevard to the proposed E. Peyton Parkway intersection. The project consists of widening the existing 2-lane roadway to a 4-lane divided section, construction of a new traffic signal, and any required utility relocations to accommodate the widening. These improvements will increase the roadway's capacity and provide safety upgrades through the addition of paved shoulders, bike lanes, and sidewalks.

In addition, there will likely be considerable tax benefits for the City of Jacksonville associated with the improvements to Race Track Road. The roadway improvements will allow for properties along this corridor to be developed from unimproved parcels into commercial, multifamily, and mixed-use developments. These development changes will increase the tax base of the parcels.

Assistance for the project is being provided by private developers through right of way dedication, wetland mitigation, and private property to provide the required stormwater management for the road. These additions to the project are key factors to allow for the improvement to happen at a lower cost to the City of Jacksonville. Please find enclosed the following items:

1. Project Budget
2. Exhibit showing limits of roadway widening (black and white)
3. Exhibit showing limits of roadway widening (color aerial)
4. East street view photo of existing 2-lane roadway
5. West street view photo of existing 2-lane roadway

We look forward to working with the City of Jacksonville and ask that you please don't hesitate to call us with any questions.

Sincerely,
England-Thims & Miller, Inc.

A handwritten signature in dark ink, appearing to read "Matt Maggioro".

Matt Maggioro, P.E.
Executive Vice President, Shareholder

England-Thims & Miller, Inc.

ENGINEERS • PLANNERS • SURVEYORS • GIS • LANDSCAPE ARCHITECTS
Jacksonville • Palm Coast
CA-00002584 LC-0000316

RACE TRACK ROAD WIDENING PROJECT BUDGET

ITEM	DESCRIPTION	COJ COST
1	General Roadway Construction - Section A	\$2,540,000
2	General Roadway Construction - Section B	\$690,000
3	General Roadway Construction - Section C	\$550,000
4	Stormwater Pond Construction	\$500,000
5	Traffic Signalization	\$700,000
6	Unsuitable Soil Removal	\$500,000
7	JEA Water and Reuse Relocation	\$800,000
8	Telecommunication Relocation	\$150,000
9	Landscaping	\$350,000
10	Irrigation	\$150,000
11	Surveying	\$100,000
12	Engineering Design	\$675,000
13	Wetland Permitting	\$35,000
14	FDOT Permitting	\$30,000
15	Geotechnical Exploration/ Construction Testing	\$45,000
16	Traffic Signal Mast Arm Structural Design	\$20,000
17	Design Fee (Owner's Contingency)	\$90,000
18	Permit Fees (budget)	\$20,000
19	Post Design Services	\$50,000
20	Unknown Utility Conflicts (Owner's Contingency)	\$200,000
21	CEI	\$350,000
	Subtotal	\$8,545,000
	Contingency 25%	\$2,136,250
	Budget Total	\$10,681,250

*Becton amendment;
remove from
CIP - located
in St Johns
County*

app

Project Length

Length = 0.56 miles

Historical Roadway Construction Cost Data

Unit Cost for 4-lane Suburban Roadway with Paved Shoulders Outside and Curbed Median = \$4,905,654 per mile
(This is FDOT Suburban Roadway cost as of July 2020)

The budget (assume 2 years of 15% annual price increase) = \$6,487,727 per mile

Notes:

1. This Preliminary Opinion of Probable Cost is based in part on FDOT Average Costs per Centerline Mile and was formulated prior to final design work.
2. The Utility Relocation Costs listed are estimates only. Actual utility relocations required, and their costs will be determined during final design.
3. Wetland Mitigation will be provided by developer.
4. R/W for pond is provided by developer.
5. Road R/W is provided by developer.

LEGEND

	WORK WITHIN SECTION A (COJ ROW)
	WORK WITHIN SECTION B (SJC ROW)
	WORK WITHIN SECTION C (PDOT ROW)

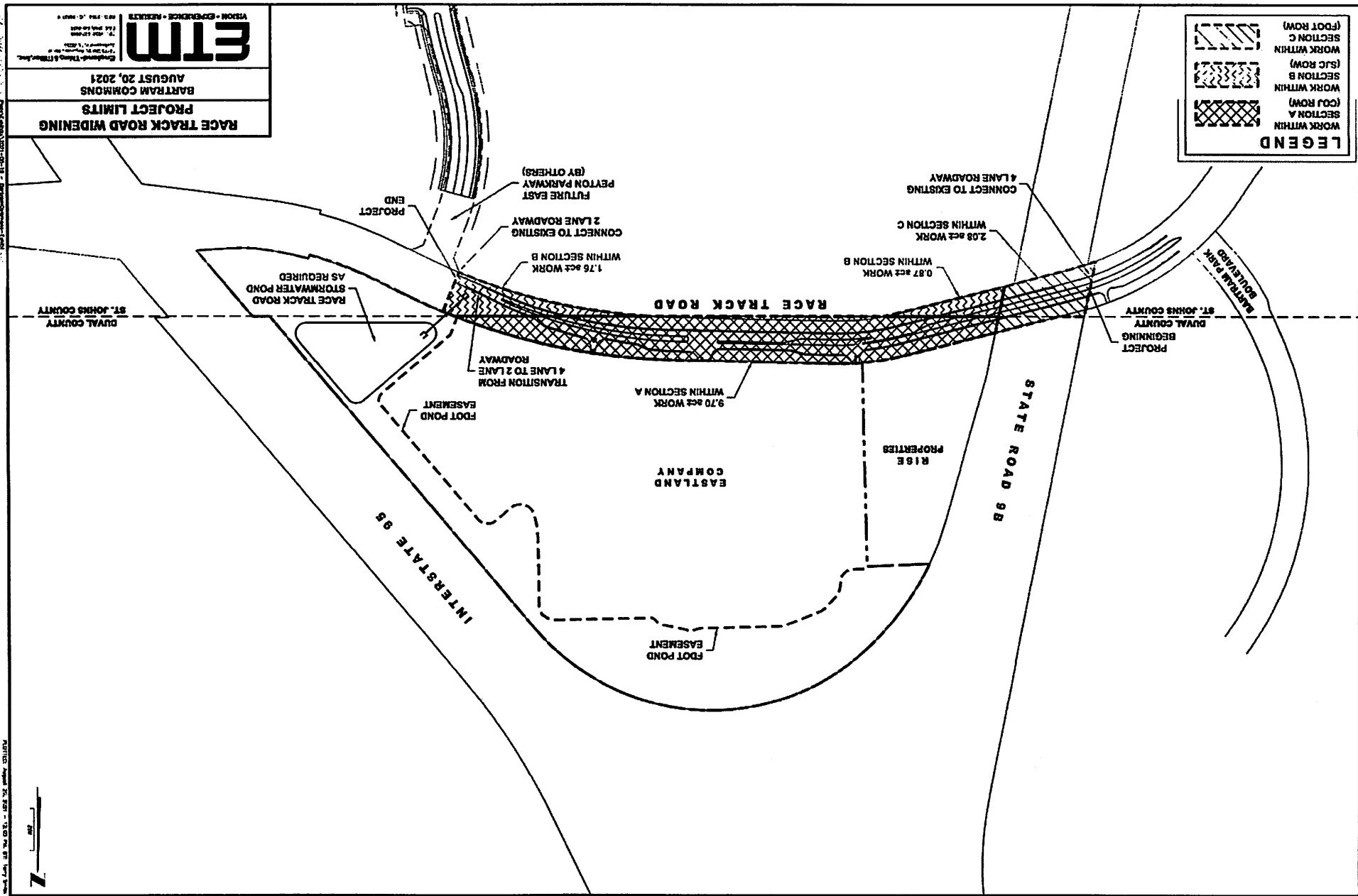

RACE TRACK ROAD WIDENING
PROJECT LIMITS
BARTRAM COMMONS
AUGUST 20, 2021

ETM
 VISION - EXPERIENCE - RESULTS
 1001 N. 1st St., Suite 100
 Jacksonville, FL 32202
 904.251.1234
 etm.com



**RACE TRACK ROAD WIDENING
PROJECT LIMITS**
BARTRAM COMMONS
AUGUST 20, 2021

ETM
VISION • EXPERIENCE • RESULTS
800-334-1100
1000 N. 1st St., Suite 100
Tampa, FL 33602
www.etm-inc.com

LEGEND	
WORK WITHIN SECTION A (COJ ROW)	[Symbol]
WORK WITHIN SECTION B (SJC ROW)	[Symbol]
WORK WITHIN SECTION C (FDOT ROW)	[Symbol]

EAST VIEW

5403 Race Track Rd



Exit Street View

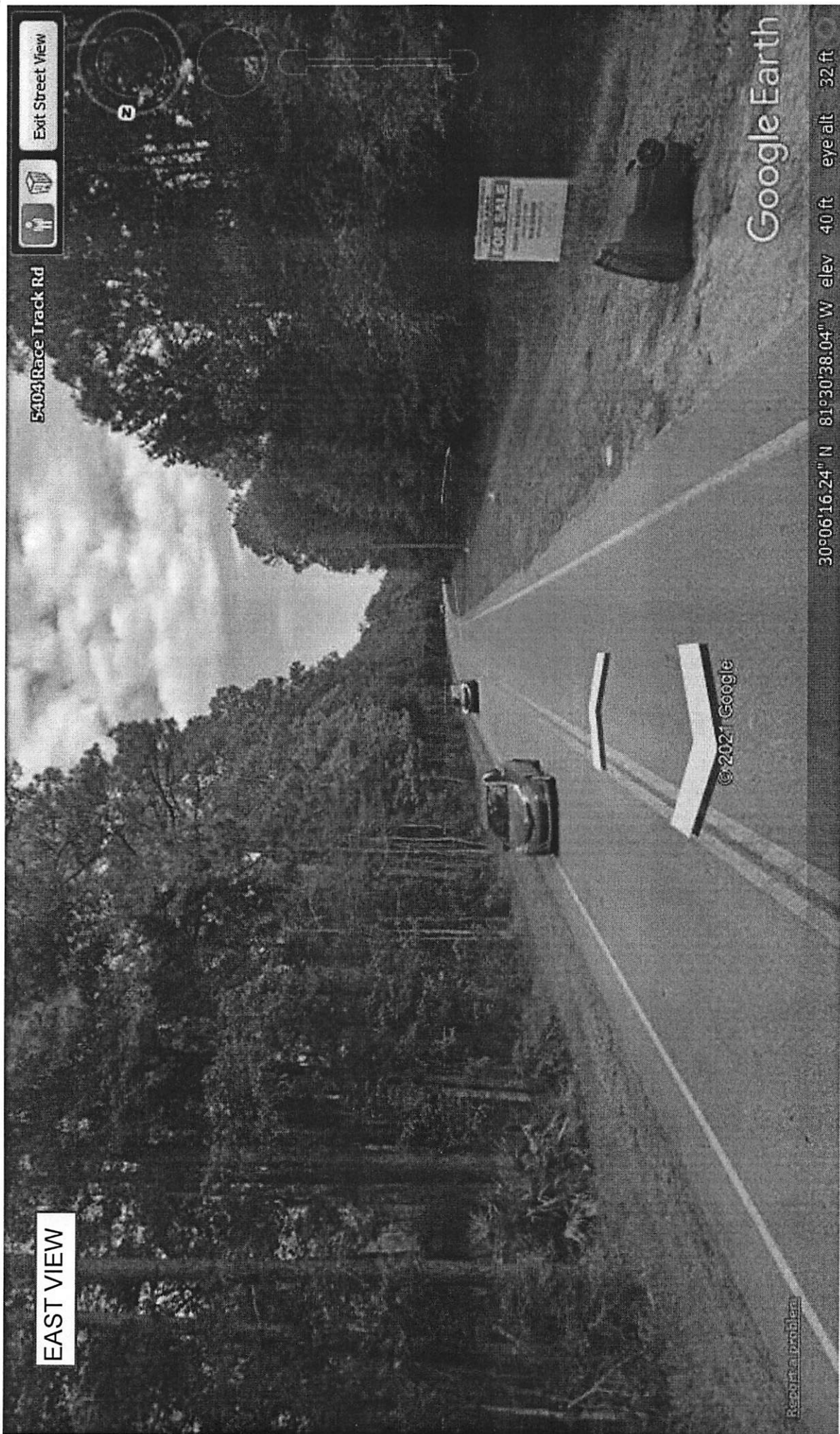

Google Earth

© 2021 Google

Report a problem

30°06'16.24" N 81°30'38.04" W elev 40 ft eye alt 32 ft

WEST VIEW

5404 Race Track Rd



Exit Street View

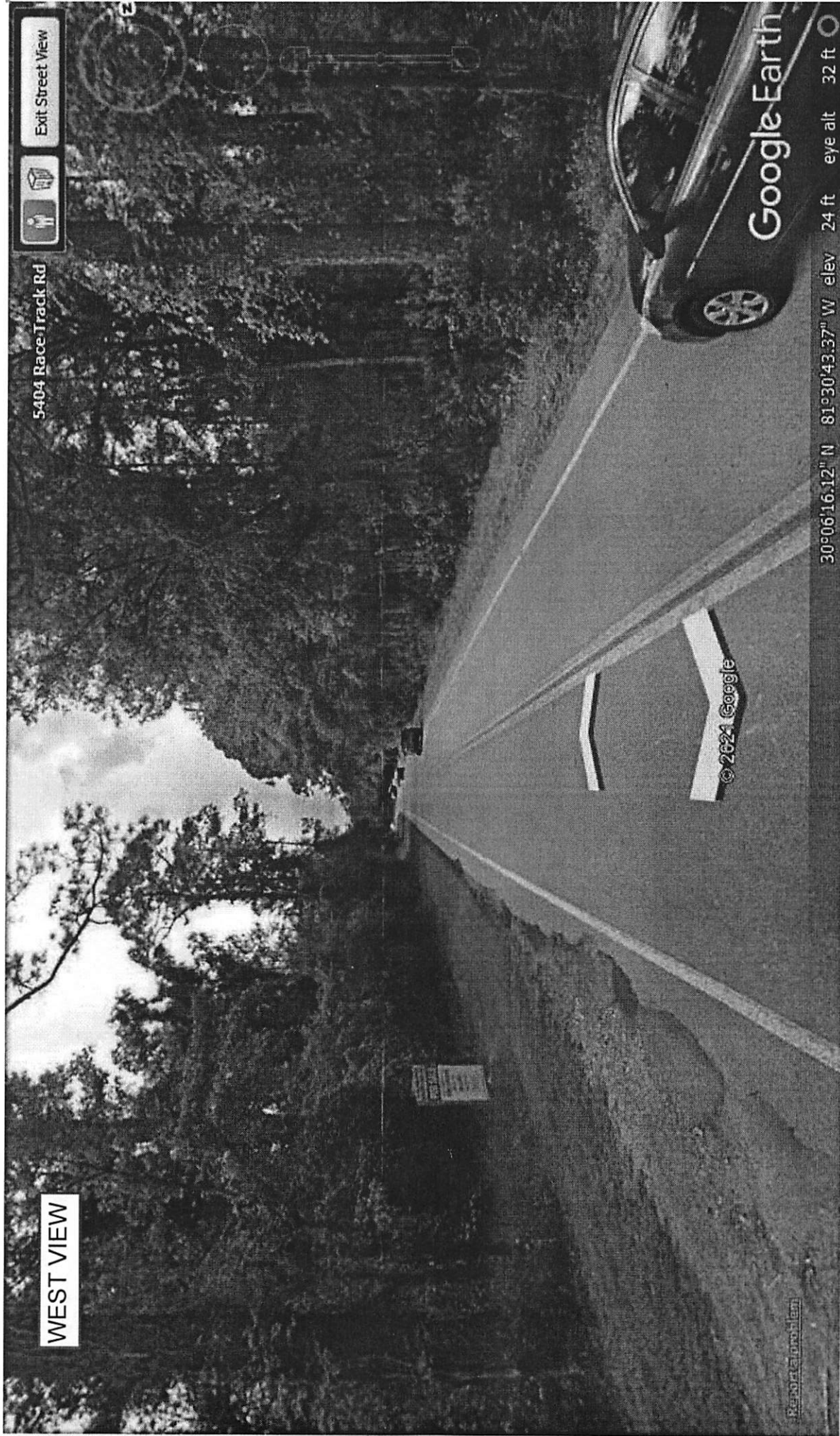

© 2024 Google

Google Earth

30°06'16.12" N 81°30'43.37" W elev 24 ft eye alt 32 ft

Report a problem